

CALIPER SPECIFICATION

BORE SIZE	38.10 x 41.30 (1.50"x1.625")
PISTON AREA / PAD	24.68 cm²
DISC DIA. MAX.	330.00
DISC THICKNESS MAX.	28.00
DISC THICKNESS MIN. (WORN CONDITION)	26.00 (DIFFERENTIAL WEAR NOT TO EXCEED 0.5mm SIDE TO SIDE)
WORKING PRESSURE	SEE DATA SHEET P14.329 (AVAILABLE FROM AP RACING TECHNICAL DEPT.)
HYDRAULIC FEED	M10 x 1.0
DRY WEIGHT (LESS PADS)	2.47 kg (ESTIMATED)
PAD FAMILY	CP3215
EFFECTIVE RADIUS (ON DIA. 330.00 DISC)	139.00
'PL' DIMN.	60.36
OFFSET 'C' DIMN.	46.86
MTG. HOLE CENTRES 'D' DIMN.	152.00
PAD FRICTION MATERIAL MIN. THICKNESS	2.50
PAD RETENTION	LEDGES
TIGHTENING TORQUES	BLEED SCREW : 17Nm HYDRAULIC FEED : 25Nm RETAINER BOLT : 19Nm
CORROSION PROTECTION	FLUID RESISTANT PAINT FINISH – ALUMINIUM BODY. BOOT TYPE DIRT SEALS.

CALIPER POSITIONING CHART

RHT	RIGHT HAND TRAILING (BEHIND AXLE)
LHT	LEFT HAND TRAILING (BEHIND AXLE)
RHL	RIGHT HAND LEADING (IN FRONT OF AXLE)
LHL	LEFT HAND LEADING (IN FRONT OF AXLE)

PART NUMBERING CONVENTION

PART NUMBER*	DESCRIPTION
CP9200-2	RHT – SIDE FEED – NO ANTI KNOCK BACK SPRING
CP9200-3	LHT – SIDE FEED – NO ANTI KNOCK BACK SPRING
CP9200-4	RHL – SIDE FEED – NO ANTI KNOCK BACK SPRING
CP9200-5	LHL – SIDE FEED – NO ANTI KNOCK BACK SPRING

\* SEE WEBSITE & CATALOGUE FOR LATEST PAINT OPTIONS, DENOTED BY  
AN ADDITIONAL PART NUMBER SUFFIX

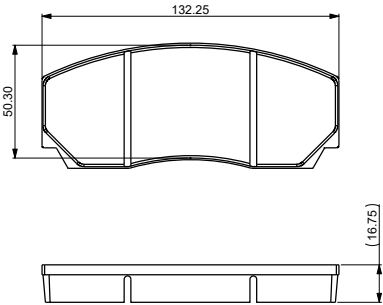
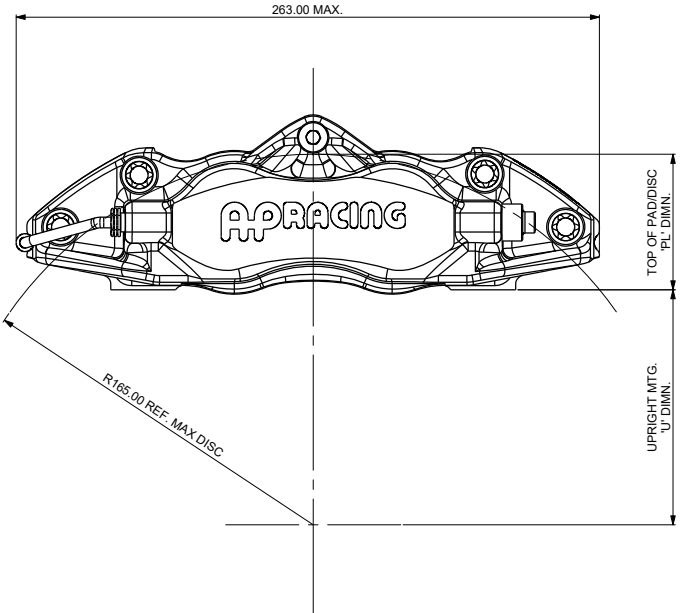
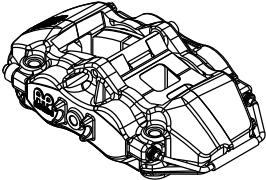
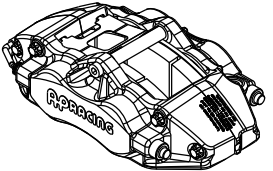

CP3215 PAD FAMILY  
PAD AREA (MAX.) - 76.30 CM²

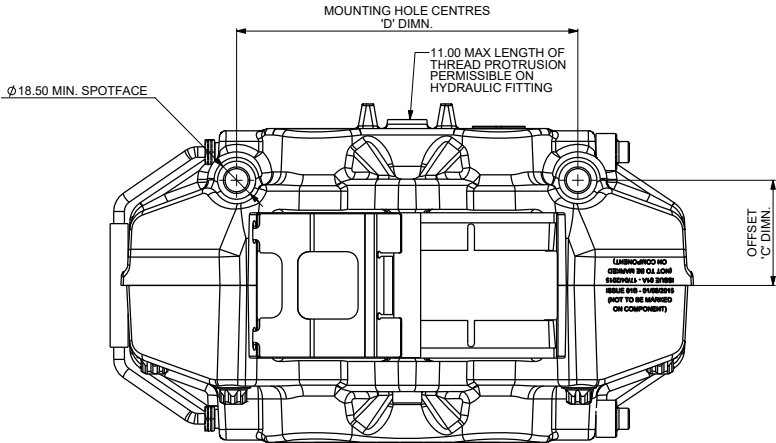

B1

INSTALLATION  
DRAWING

IF THIS DOCUMENT IS PRINTED IN HARDCOPY,  
IT IS FOR INFORMATION USE ONLY AND THEREFORE  
IS NOT SUBJECT TO UPDATING CONTROLS. ALWAYS  
REFER TO SOLIDWORKS VIEWER FOR LATEST ISSUE



THIS DRAWING IS CONFIDENTIAL AND IS SUPPLIED ON THE EXPRESS CONDITION THAT  
IT SHALL NOT BE LOANED OR COPIED OR DISCLOSED TO ANY OTHER PERSON OR USED  
FOR ANY OTHER PURPOSE WITHOUT THE WRITTEN CONSENT OF AP RACING LTD.



AP Racing  
Wheler Road  
Coventry  
CV3 4LB  
Tel: +44 (0)24 7663 9595  
Fax: +44 (0)24 7663 9559  
e-mail: sales@apracings.co.uk  
Web site: HTTP://www.apracings.com

Issue No.	Alterations		
	Date & No.	Particulars	Zone Initials
-	-	SEE SHEET 1 FOR ISSUE INFORMATION.	-

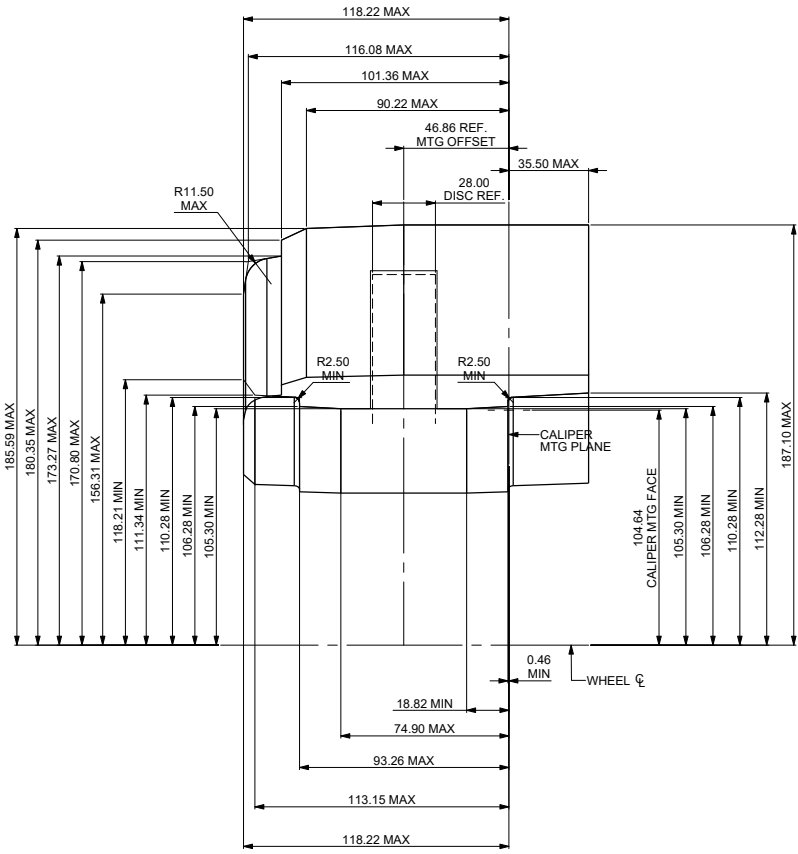

CALIPER INSTALLED PROFILE  
ON 330 x 28.00 DISC

SCALE 1:1		SHEET 2 OF 2	
DRAWN		A.THORPE	
APPROVED			
DERIVED FROM			
TITLE			
4-PISTON CALIPER INSTALL'N			
DRAWING 330 MAX x 28 DISC			
DRG NO.		CP9200-1CD	